

# Ventilation Professional solution for ventilation

**REDI**

1.5 VENTILATION



# The New Air System

## Grill with removable winged insert

All ventilation grills consist of two different parts: one is perimetrical and the other one is central (with wings) and removable in order to remove easily mosquito mesh. You have to check at least once time per year to inspect the pipe.

## Round built-in grills

To remove the grill it is sufficient to rotate anticlockwise holding the wings and extracting.



## Round push-in grills - PATENTED

To remove the grill it is sufficient to rotate anticlockwise holding the wings and extracting.



## Square push-in grills - PATENTED

To remove the grill to insert the screwdriver in the special slit and to extract it without forcing.



## The grills have the same air flow with or without the mosquito mesh

Grills with fly mesh always permit the same air flow of the one without fly mesh. That's possible because uses a 70% open section grid that warrants an air flow always superior to the one it is linked to. The final air flow is not reduced. Because the grid is distanced from the wings. Therefore we can affirm that all ventilation grills have the same air flow.

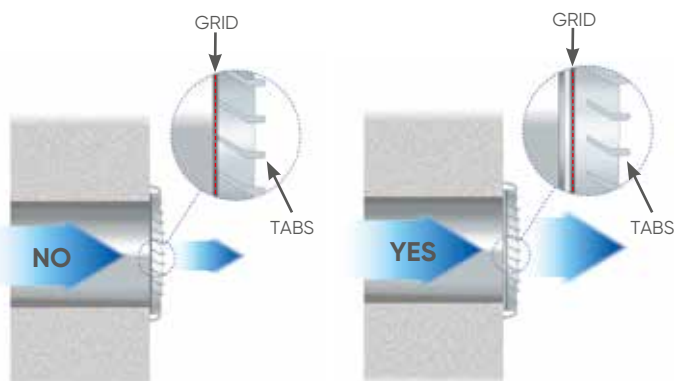

## 30° Inclined tabs

The wings of the grill have 30° inclination in order to permit the maximum air flow and to be rain proof.



## Materials and colours

Grills are made with:

- **ABS** shock resistant with additive anti UV in order to guarantee a greater resistance to sun rays.
- **Colours:** White, Copper
- **PVC** the structure and the materials are particularly resistant and it permits the use of grills in places subject to shocks.
- **Colours:** Grey, Brown

## Aluminium mosquito mesh with 70% open section

In grills uses aluminium insect proof grid with 70% open section, in order to permit a high air flow, superior to the one of the grill. The mosquito mesh is not electrostatic; which means it doesn't attract dust, unlike the plastic ones that favour obstruction.

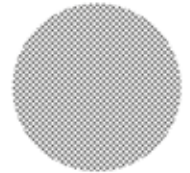

## Design - Models - Dimensions - PATENTED MODELS

The round shape grills has been projected to differentiate the product and to confer to the structure a greater shock resistance.

The range of products and their dimensions have been examined to meet all customer's requirements.

## Screw fixing

All grills can be fixed with screws. Inside the perimetrical side of the grill there are some holes that can be seen only taking off the winged part. In this case the spring support must be removed.

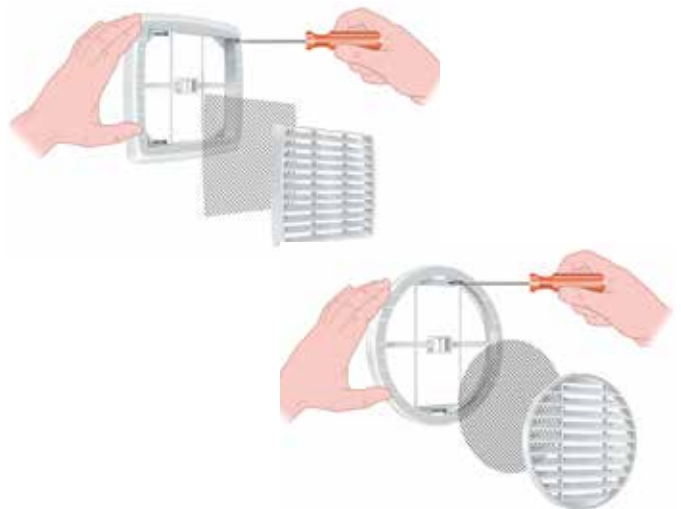

**Spring fixing - PATENTED**

For a quick installation, grills have a carriage spring fixed to a foldable support that blocks during the period of use. This kind of spring permit to apply the grill to pipes or holes with different diameters. When the hole is too close to the floor or to the ceiling, and is not installed in central axe with the grill, only one part of the spring can bend compensating the offset.



**Example of installation**

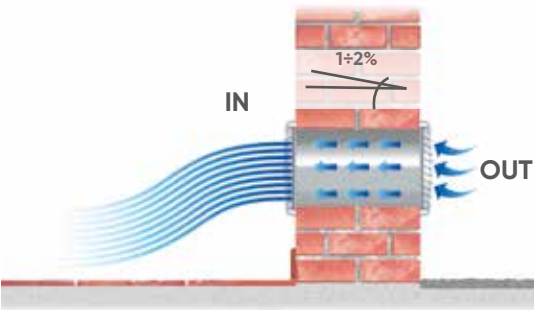

**Silicone fixing**

For permanent fixing or water insulation, you can seal the exterior edge of the grill with silicone without compromising the possibility of extracting the winged part and the grid.

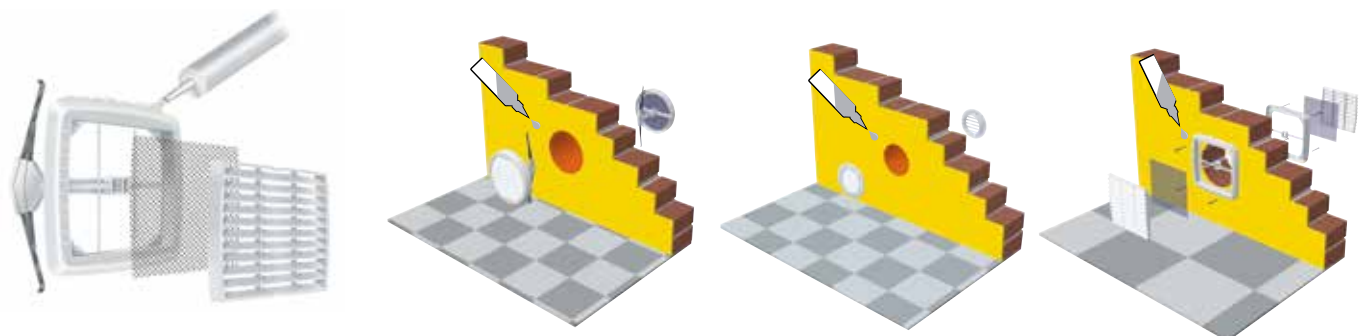

**Technical characteristics**

Proprietà	Test	Size	Result
<b>Mechanical characteristics:</b>			
Shock resistance IZOD with 3,2 mm cut	ISO R180/4A	j/m	190-250
<b>Thermic characteristics:</b>			
Vicat softening temperature	ISO 306/A 120 (10N)	°C	106-108
	ISO 306/B 120 (50N)	°C	98-100
HDT deflection temperature	ISO 75 1,82 N/mm <sup>2</sup>	°C	98-100
	ISO 75 0,45 N/mm <sup>2</sup>	°C	102-104
Thermal linear expansion coefficient	DIN 53752	10 <sup>-4</sup> /K	0,8-1,1
Flaming:	IEC 695 2-1	°C	650

**How to clean**



**Ventilation**

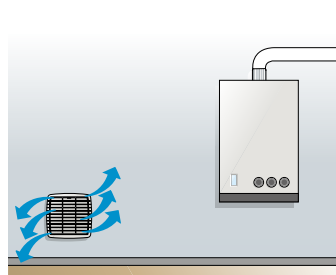

**Aeration**

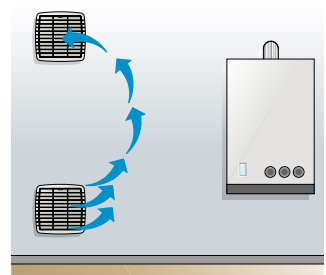

# Guidelines













## VENTILATION

(without presence of gas devices)

Air flow min. cm<sup>2</sup> 120

UNI CIG 7129/92



<p>Free air cm<sup>2</sup> <b>14</b></p> <p>Built-in round grilles Ø 63</p>  <p>PIPE Ø 63 Free air cm<sup>2</sup> 28</p> 	<p>Free air cm<sup>2</sup> <b>25</b></p> <p>Built-in round grilles Ø 80</p>  <p>Free air cm<sup>2</sup> <b>47</b></p> <p>Round push-in vents Ø 135</p>  <p>PIPE Ø 80 Free air cm<sup>2</sup> 47</p> 	<p>Free air cm<sup>2</sup> <b>42</b></p> <p>Built-in round grilles Ø 100</p>  <p>Free air cm<sup>2</sup> <b>60</b></p> <p>Round push-in vents Ø 135</p>  <p>PIPE Ø 100 Free air cm<sup>2</sup> 73</p> 	<p>Free air cm<sup>2</sup> <b>64</b></p> <p>Built-in round grilles Ø 125</p>  <p>Free air cm<sup>2</sup> <b>60</b></p> <p>Round push-in vents Ø 135</p>  <p>PIPE Ø 125 Free air cm<sup>2</sup> 115</p> 	<p>Free air cm<sup>2</sup> <b>100</b></p> <p>Round push-in vents Ø 160</p> 	<p>Free air cm<sup>2</sup> <b>115</b></p> <p>Square push-in vents 175</p> 
---	---	---	---	--	---

Air flow cm<sup>2</sup> 120

Air flow cm<sup>2</sup> 120

Air flow cm<sup>2</sup> 180

Air flow cm<sup>2</sup> 200



Free air cm<sup>2</sup> 100

Free air cm<sup>2</sup> 130

Free air cm<sup>2</sup> 130

Free air cm<sup>2</sup> 130

Free air cm<sup>2</sup> 130

Free air cm<sup>2</sup> 188

Free air cm<sup>2</sup> 188

Free air cm<sup>2</sup> 210

Free air cm<sup>2</sup> 200

Round push-in vents  
Ø 160

Round push-in vents  
Ø 186

Square push-in vents  
⌀ 175

Round push-in vents  
Ø 186

Square push-in vents  
⌀ 175

Square push-in vents  
⌀ 210

Rectangular surface  
mounted vents  
⌀175x270

Round push-in vents  
Ø 230

Square push-in vents  
⌀210



PIPE  
Ø 140  
Free air  
cm<sup>2</sup> 144

PIPE  
Ø 160  
Free air  
cm<sup>2</sup> 188

PIPE  
Ø 200  
Free air  
cm<sup>2</sup> 294



# Guidelines

## AIR SYSTEM:

- Acoustic ventilation solution
- Ventilation grills

### Functions:

- Allow change of ambient air.
- Compling with the safety norms related to kitchens or boiler rooms.
- Compling with the norms related to ambient noise limit.

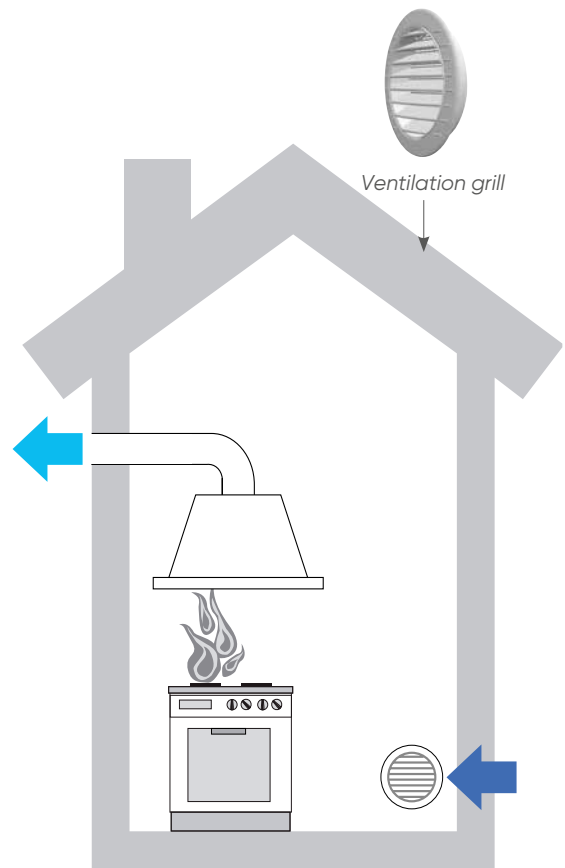

## Acoustic solution for ventilations

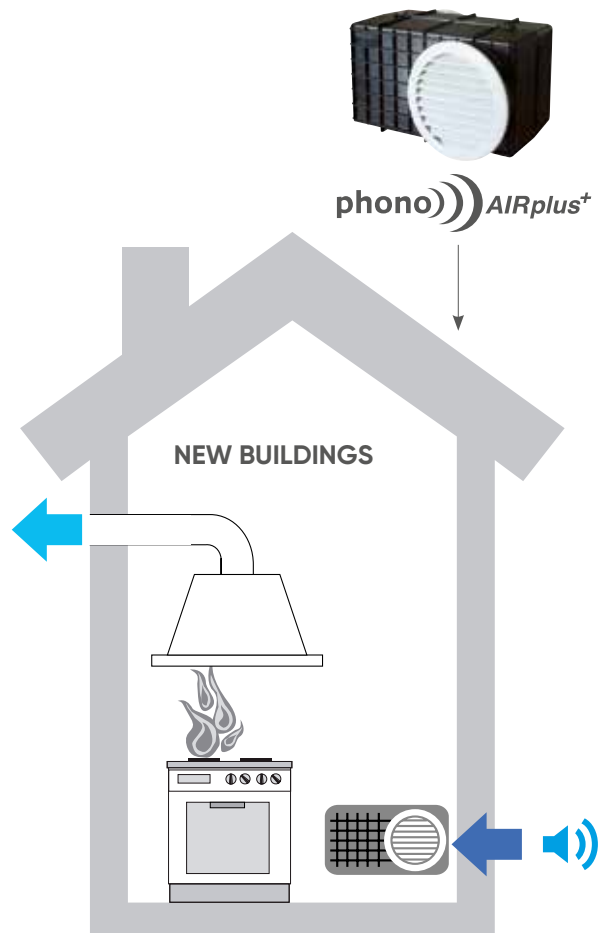
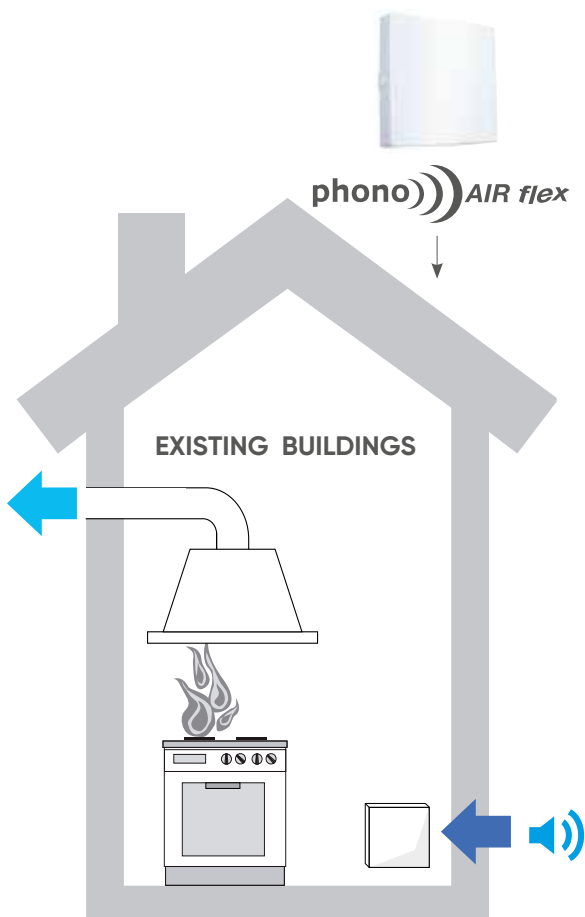



phono))) AIRplus+

**Sound-proof air kit**

**Echangeur d'air avec abattement acoustique**  
**Intercambiador de aire con reducción acústica**

Dim (mm)	Reference			Colour
350x200x165	1PA1608	1	48	Black



**Air Flow**  
100 cm<sup>2</sup>



**-47 dB**



Included in the package:

- 2 pcs. grids Ø160 with mesh (inspectable)
- Protective cover
- Extension pipe not included

Advantages:

- Compact (10,8 LT)
- Reinforced box
- No maintenance

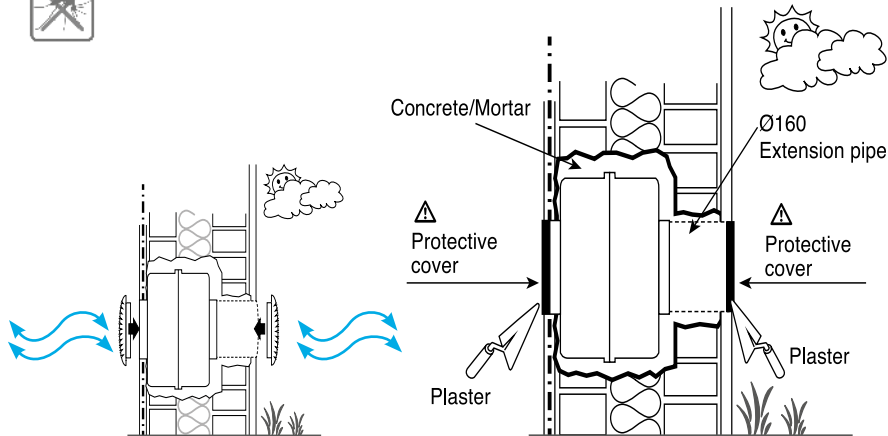
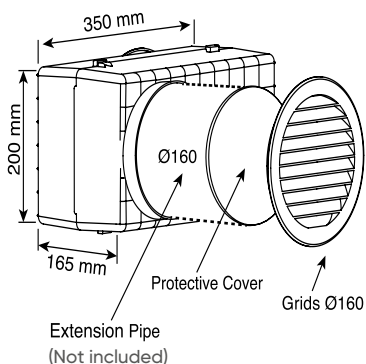

**-42 dB**



**EUSTACHIO 160**

*Eustachio*))) 160

Ø (mm)	L (mm)	Reference			Note
150	288	EPA0603	1	1.296	Colour white

Air flow 100 cm<sup>2</sup>

Inserted in the ventilation pipe Ø160

Ideal for renovation projects in existing buildings.

N.B.: Built-in round grille Ø160 not included



### Acoustic ventilation grill

### Grille de ventilation acoustique - Rejilla de ventilación acústica

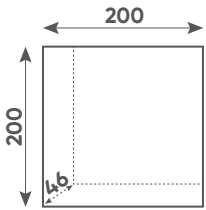

Multidiameter  
80 ÷ 140 mm



Air Flow  
100 cm<sup>2</sup>



-32 dB



Dim (mm)	Reference			Colour	Note
200x200	EPAGF03*	1	240	White	Multidiameter Ø: 80-100-125-140 mm Supplied with screws and gasket

\*upon request

#### Spare parts: screw

Reference			Note
EKVGFO0*	30	-	

\*upon request

#### Technical features:

- Made of ABS (UV resistant)
- Air flow: 100 cm<sup>2</sup> (UNI CIG GAS)
- Certified acoustic performance: -32 dB
- Double density noise insulation
- Aluminium net (anti insects and dust)
- Multi diameter: (80, 100, 125, 140 mm)
- Suitable for indoor and outdoor installations
- Integrated spirit level to the right installation
- Screws included



Bathrooms & rooms with boilers



Kitchens

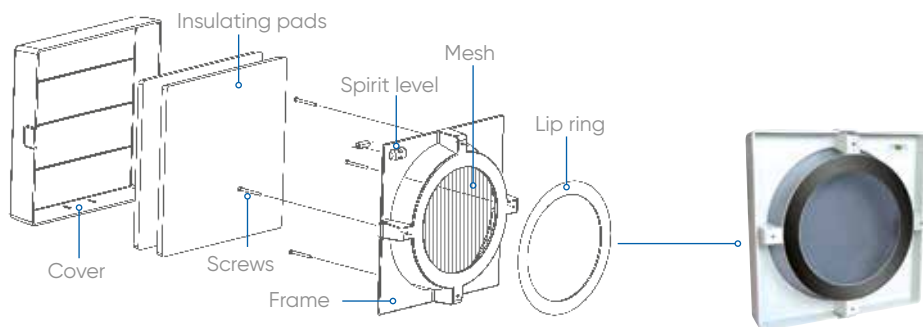

#### Installation sequence:





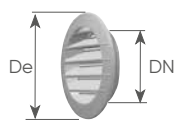

AIR FLOW: 14 cm<sup>2</sup>

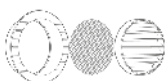

Easy inspection



**Built-in round grille Ø63**  
**Grille ronde à sceller Ø63 - Rejilla empotrable Ø63**

DN (mm)	De (mm)	Colour	Reference			Note
63	80	White	E06TIO5	10	2.400	With removable mosquito mesh

**Thermo shrinking**

DN (mm)	De (mm)	Colour	Reference			Note
63	80	White	E06TIG5	10	2.160	With removable mosquito mesh

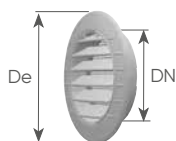

AIR FLOW: 25 cm<sup>2</sup>

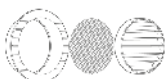

Easy inspection



**Built-in round grille Ø80**  
**Grille ronde à sceller Ø80 - Rejilla empotrable Ø80**

DN (mm)	De (mm)	Colour	Reference			Note
80	100	White	E08TIO5	10	2.400	With removable mosquito mesh

**Thermo shrinking**

DN (mm)	De (mm)	Colour	Reference			Note
80	100	White	E08TIG5	10	2.400	With removable mosquito mesh

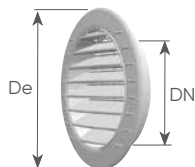

AIR FLOW: 42 cm<sup>2</sup>

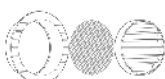

Easy inspection



**Built-in round grille Ø100**  
**Grille ronde à sceller Ø100 - Rejilla empotrable Ø100**

DN (mm)	De (mm)	Colour	Reference			Note
100	120	White	E10TIO5	10	1.440	With removable mosquito mesh
100	120	Copper	E10TIO*	10	1.440	With removable mosquito mesh

**Thermo shrinking**

\*upon request

DN (mm)	De (mm)	Colour	Reference			Note
100	120	White	E10TIG5	10	1.440	With removable mosquito mesh

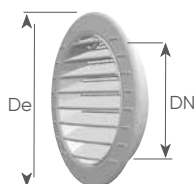

AIR FLOW: 64cm<sup>2</sup>

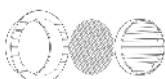

Easy inspection



**Built-in round grille Ø125**  
**Grille ronde à sceller Ø125 - Rejilla empotrable Ø125**

DN (mm)	De (mm)	Colour	Reference			Note
125	140	White	E12TIO5	5	960	With removable mosquito mesh

**Thermo shrinking**

DN (mm)	De (mm)	Colour	Reference			Note
125	140	White	E12TIG5	1	960	With removable mosquito mesh

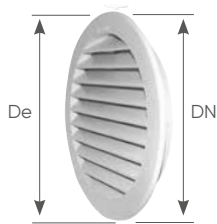
AIR FLOW: 120 cm<sup>2</sup>**Built-in round grille Ø160****Grille ronde à sceller Ø160 - Rejilla empotrable Ø160**

DN (mm)	De (mm)	Colour	Reference			Note
156	190	White	V16TI05	5	600	

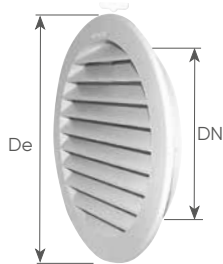
AIR FLOW: 132 cm<sup>2</sup>**Built-in round grille Ø200****Grille ronde à sceller Ø200 - Rejilla empotrable Ø200**

DN (mm)	De (mm)	Colour	Reference			Note
200	238	White	V20TI05	3	-	

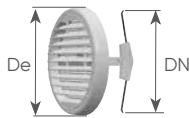
AIR FLOW: 60 cm<sup>2</sup>**Round push-in vent Ø135 (type 100)****Grille ronde avec ressort de fixation Ø135****Rejilla circular conexión a presión Ø135**

De (mm)	DN (pipe)	Colour	Reference			Note
135	63-125	White	E13TU05	5	1.200	With removable mosquito mesh
135	63-125	Copper	E13TU0R	5	1.200	With removable mosquito mesh

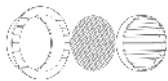

Easy inspection

**Thermo shrinking**

De (mm)	DN (pipe)	Colour	Reference			Note
135	63-125	White	E13TUG5	5	1.200	With removable mosquito mesh
135	63-125	Copper	E13TUGR	5	1.200	With removable mosquito mesh

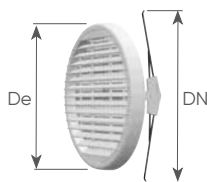
AIR FLOW: 100 cm<sup>2</sup>**Round push-in vent Ø160 (type 125)****Grille ronde avec ressort de fixation Ø160****Rejilla circular conexión a presión Ø160**

De (mm)	DN (pipe)	Colour	Reference			Note
160	80-140	White	E16TU05	5	600	With removable mosquito mesh
160	80-140	Copper	E16TU0R	5	600	With removable mosquito mesh

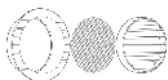

Easy inspection

**Thermo shrinking**

De (mm)	DN (pipe)	Colour	Reference			Note
160	80-140	White	E16TUG5	5	720	With removable mosquito mesh

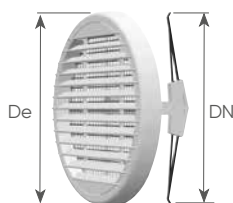

AIR FLOW: 130 cm<sup>2</sup>



**Round push-in vent Ø186 (type 160)**  
**Grille ronde avec ressort de fixation Ø186**  
**Rejilla circular conexión a presión Ø186**

De (mm)	DN (pipe)	Colour	Reference			Note
186	100-160	White	E18TU05	5	600	With removable mosquito mesh
186	100-160	Copper	E18TU0R	5	600	With removable mosquito mesh

**Thermo shrinking**

De (mm)	DN (pipe)	Colour	Reference			Note
186	100-160	White	E18TUG5	5	720	With removable mosquito mesh

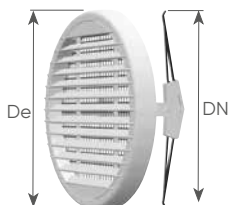

AIR FLOW: 210 cm<sup>2</sup>



**Round push-in vent Ø230 (type 200)**  
**Grille ronde avec ressort de fixation Ø230**  
**Rejilla circular conexión a presión Ø230**

De (mm)	DN (pipe)	Colour	Reference			Note
230	100-200	White	E23TU05	3	288	With removable mosquito mesh

**Thermo shrinking**

De (mm)	DN (pipe)	Colour	Reference			Note
230	100-200	White	E23TUG5	3	240	With removable mosquito mesh
230	100-200	Copper	E23TUGR	3	240	With removable mosquito mesh

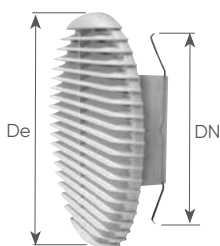

AIR FLOW: 300 cm<sup>2</sup>

**Round push-in vent Ø260 (type 250)**  
**Grille ronde avec ressort de fixation Ø260**  
**Rejilla circular conexión a presión Ø260**

De (mm)	DN (pipe)	Colour	Reference			Note
260	160-250	White	E26TU05	2	348	

**Built-in air vent Ø32 - 60 (without mosquito mesh)**  
**Grille ronde pour caissons de volet roulant (sans moustiquaire)**  
**Rejilla de ventilacion empotrable (sin mosquitera)**

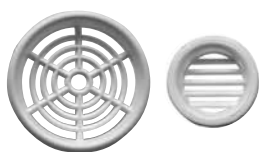

De (mm)	DN (pipe)	Colour	Reference			Note
32	39	White	VAE3205	100	-	

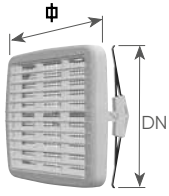
AIR FLOW: **130 cm<sup>2</sup>****Square push-in vent 175x175****Grille carrée avec ressort de fixation 175x175****Rejilla cuadrada conexión a presión 175x175**

φ (mm)	DN (pipe)	Colour	Reference			Note
175	100-160	White	E17QU05	5	600	With removable mosquito mesh

**Thermo shrinking**

φ (mm)	DN (pipe)	Colour	Reference			Note
175	100-160	White	E17QUG5	5	600	With removable mosquito mesh

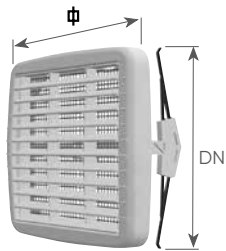
AIR FLOW: **200 cm<sup>2</sup>****Square push-in vent 210x210****Grille carrée avec ressort de fixation 210x210****Rejilla cuadrada enchufe rápido 210x210**

φ (mm)	DN (pipe)	Colour	Reference			Note
210	125-200	White	E21QU05	3	288	With removable mosquito mesh

**Thermo shrinking**

φ (mm)	DN (pipe)	Colour	Reference			Note
210	125-200	White	E21QUG5	3	288	With removable mosquito mesh

AIR FLOW: **130 cm<sup>2</sup>****Square surface mounted vent 175x175****Grille carrée à visser 175x175****Rejilla cuadrada montaje en superficie 175x175**

φ (mm)	DN (pipe)	Colour	Reference			Note
175	160	White	E18QS05	5	600	With removable mosquito mesh

AIR FLOW: **200 cm<sup>2</sup>****Square surface mounted vent 210x210****Grille carrée à visser 210x210****Rejilla cuadrada montaje en superficie 210x210**

φ (mm)	DN (pipe)	Colour	Reference			Note
210	200	White	E22QS05	3	432	With removable mosquito mesh

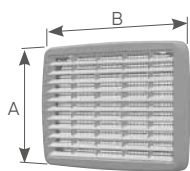

AIR FLOW: 200 cm<sup>2</sup>

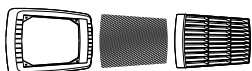

Easy inspection

**Rectangular surface mounted vents 175x270**  
**Grille rectangulaire à visser 175x270**  
**Rejilla rectangular montaje en superficie 175x270**

AxB (mm)	Colour	Reference			Note
175x270	White	E172705*	2	384	ABS
175x270	Copper	E17270R	2	384	ABS

Ø160



Ø125



\*upon request



AIR FLOW: 170 cm<sup>2</sup>

**Rectangular built-in vents**  
**Grille rectangulaire à visser - Rejilla rectangular para atornillar**

Dim (mm)	Dim Carving	Colour	Reference			Note
370x123	335x95	White	V371205	6	1800	



AIR FLOW: 280 cm<sup>2</sup>

**Rectangular built-in vents**  
**Grille rectangulaire à visser - Rejilla rectangular para atornillar**

Dim (mm)	Dim Carving	Colour	Reference			Note
370 x 223	335 x 185	White	V372205	5	40	

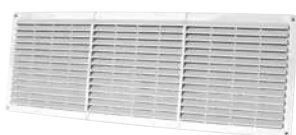

AIR FLOW: 630 cm<sup>2</sup>

**Rectangular built-in vents**  
**Grille rectangulaire à visser - Rejilla rectangular para atornillar**

Dim (mm)	Colour	Reference			Note
230x630	White	VGR6305	4	-	

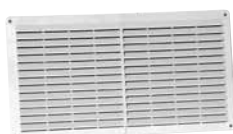

AIR FLOW: 300 cm<sup>2</sup>



**Rectangular built-in vents**  
**Grille rectangulaire à visser - Rejilla rectangular para atornillar**

Dim (mm)	Colour	Reference			Note
230x430	White	VGR4305	4	256	

### Square grill with adjustable air flow

#### Grille carrée à fermeture réglable - Rejilla cuadrada con apertura regulable



AxB (mm)	CxD (mm)	Ø (mm)	Colour	Reference			Note
150x150	97x100	-	White	EGQ5005	1	1.360	Surface mounted
190x190	131x131	-	White	EGQ9005*	1	780	Surface mounted

\*upon request

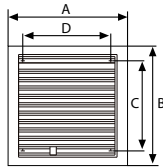
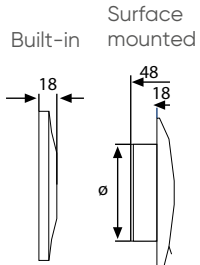



### Round built-in grill with mosquito net (copper)

#### Grille ronde à sceller avec moustiquaire (cuivre)

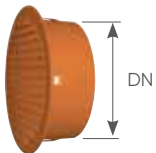
#### Rejilla empotrable circular con filtro anti-mosquitos (cobre)



DN (mm)	Free Air	Reference			Note
80	24,5	GTI08RA	24	3.168	
100	70	GTI10RA	1	480	
120	84	GTI12RA	24	480	
140	98	GTI14RA*	24	480	
150	98	GTI15RA*	24	1.080	
160	98	GTI16RA	24	576	
200	140	GTI20RA*	12	240	

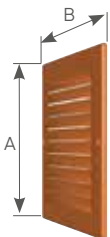

\*upon request



### Rectangular and square grill with mosquito net (copper)

#### Grille carrée à visser avec moustiquaire (cuivre)

#### Rejilla rectangular y cuadrada con filtro anti-mosquitos (cobre)

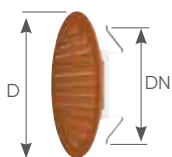

AxB (mm)	Free Air	Reference			Note
140x140	70	GRS14RA	1	1.000	
140x250	101,5	GRS25RA	1	1.000	
140x350	150,5	GRS35RA	1	500	
230x230	193	GRS23RA	1	400	



### Round push-in grill with mosquito net (copper)



#### Grille ronde avec ressort de fixation et moustiquaire (cuivre)

#### Rejilla circular conexión a presión con filtro anti-mosquitos (cobre)

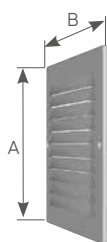
D (mm)	DN Min	Pipe	Free Air	Reference			Note
135	80	125	70	GTM13RA	1	-	
175	125	160	98	GTM17RA	1	500	
230	160	200	140	GTM23RA	20	900	



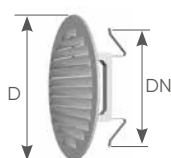

**Rectangular and square grill with mosquito net (aluminium)**  
**Grille carrée à visser avec moustiquaire (aluminium)**  
**Rejilla rectangular y cuadrada con filtro anti-mosquitos (aluminio)**

AxB (mm)	Free Air	Reference			Note
140x140	70	GRS40AL	1	1000	
140x250	101,5	GRS45AL	25	1000	
140x350	150,5	GRS50AL	25	500	
230x230	193	GRS55AL	1	400	



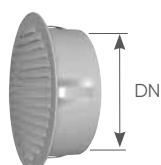

**Round push-in grill with mosquito net (aluminium)**  
**Grille ronde avec ressort de fixation et moustiquaire (aluminium)**  
**Rejilla circular enchufe rapido con filtro anti-mosquitos (aluminio)**

D (mm)	DN Min	Pipe Max	Free Air	Reference			Note
135	80	125	70	GTM30AL	25	500	
175	125	160	98	GTM35AL	25	500	
230	160	200	140	GTM40AL	25	500	



**Round push-in grill with mosquito net (aluminium)**  
**Grille ronde avec ressort de fixation et moustiquaire (aluminium)**  
**Rejilla circular conexión a presión con filtro anti-mosquitos (aluminio)**

DN (mm)	Free Air	Reference			Note
80	24,5	GTI30AL	1	960	
100	70	GTI35AL	1	-	
120	84	GTI40AL	1	-	
140	98	GTI45AL	24	480	
150	98	GTI50AL	24	1.080	
160	98	GTI55AL	12	288	
200	140	GTI65AL	12	240	