

# CMIV/CP NO – Pneumatically actuated compact diaphragm valve DN 12:15

Pneumatically actuated compact diaphragm valve with metric plain socket ends for solvent welding, Normally Open.

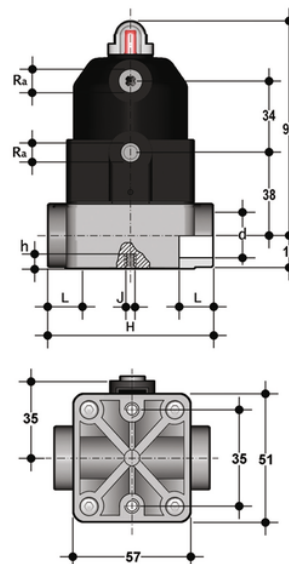

## EPDM

| Reference  | d  | DN | PN | R <sub>a</sub> | L  | H  | h | J  | g   |
|------------|----|----|----|----------------|----|----|---|----|-----|
| CMIVNO016E | 16 | 12 | 6  | G 1/4"         | 14 | 75 | 8 | M5 | 340 |
| CMIVNO020E | 20 | 15 | 6  | G 1/4"         | 16 | 75 | 8 | M5 | 340 |

## FKM

| Reference  | d  | DN | PN | R <sub>a</sub> | L  | H  | h | J  | g   |
|------------|----|----|----|----------------|----|----|---|----|-----|
| CMIVNO016F | 16 | 12 | 6  | G 1/4"         | 14 | 75 | 8 | M5 | 340 |
| CMIVNO020F | 20 | 15 | 6  | G 1/4"         | 16 | 75 | 8 | M5 | 340 |

## PTFE

| Reference  | d  | DN | PN | R <sub>a</sub> | L  | H  | h | J  | g   |
|------------|----|----|----|----------------|----|----|---|----|-----|
| CMIVNO016P | 16 | 12 | 6  | G 1/4"         | 14 | 75 | 8 | M5 | 340 |
| CMIVNO020P | 20 | 15 | 6  | G 1/4"         | 16 | 75 | 8 | M5 | 340 |

# CMIV/CP NO – Pneumatically actuated compact diaphragm valve DN 12:15

The new compact and light piston actuator in PP-GR makes the CM/CP the ideal choice for applications requiring very frequent valve operation and a long valve lifetime.

- Compact and lightweight piston actuator in PP-GR, free of exposed metallic parts, particularly suited for use in severe environmental and chemically aggressive conditions.
- High strength IXEF piston guarantees high reliability over time without maintenance.
- High visibility graduated optical position indicator protected by a transparent cap with a seal O-Ring.
- The valve is impervious to fluids containing impurities
- It has an high flow rate
- It can be installed in any position
- It has an extremely compact structure
- It is actuated by a dry running piston and does not require maintenance
- It has no protruding screws and is fully free of impurity deposits
- Allows for an easy diaphragm seal replacement
- The Standard version valve comes with a position indicator.